

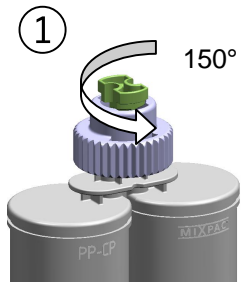

System F

Cartridge Outlet Concept

Mode of operation



To open the cartridge turn the bajonett ring counter clockwise.

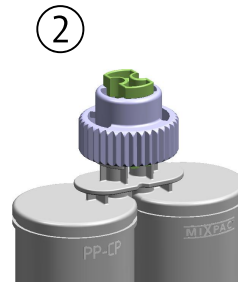

Whilst turning, the bajonett ring pulls the plug out of the cartridge.

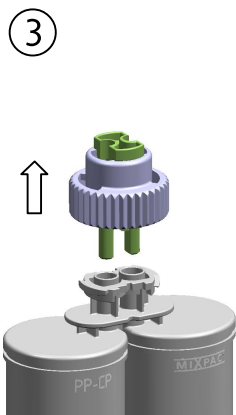

Remove plug. Keep bajonett ring in order to fasten mixer on the cartridge. Also keep plug for re-closing the cartridge.

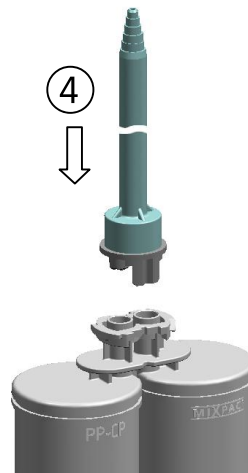

Attach mixer onto cartridge.

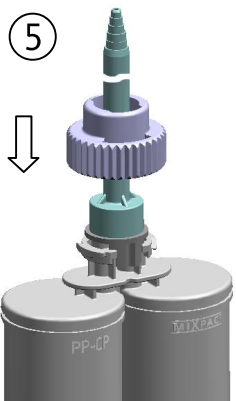

Place bajonett ring over the mixer and fix.

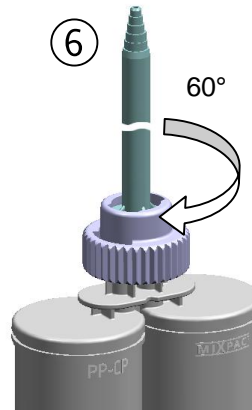

Lock bajonett ring by turning clockwise.

Cartridge is ready for dispensing.

MIXPAC ... 2-Component-Innovation

MIXPAC SYSTEMS AG
Grundstrasse 12 · CH-6343 Rotkreuz · Switzerland
TEL: +41 41 799 04 00 · FAX: +41 41 799 04 04
info@mixpac.com · www.mixpac.com

April 2006